

# AR36

ALL-IN-ONE LIQUID CPU COOLER



***User Manual***





# Product Video Information



AR36 Product Video



AR36 Installation Guide Video



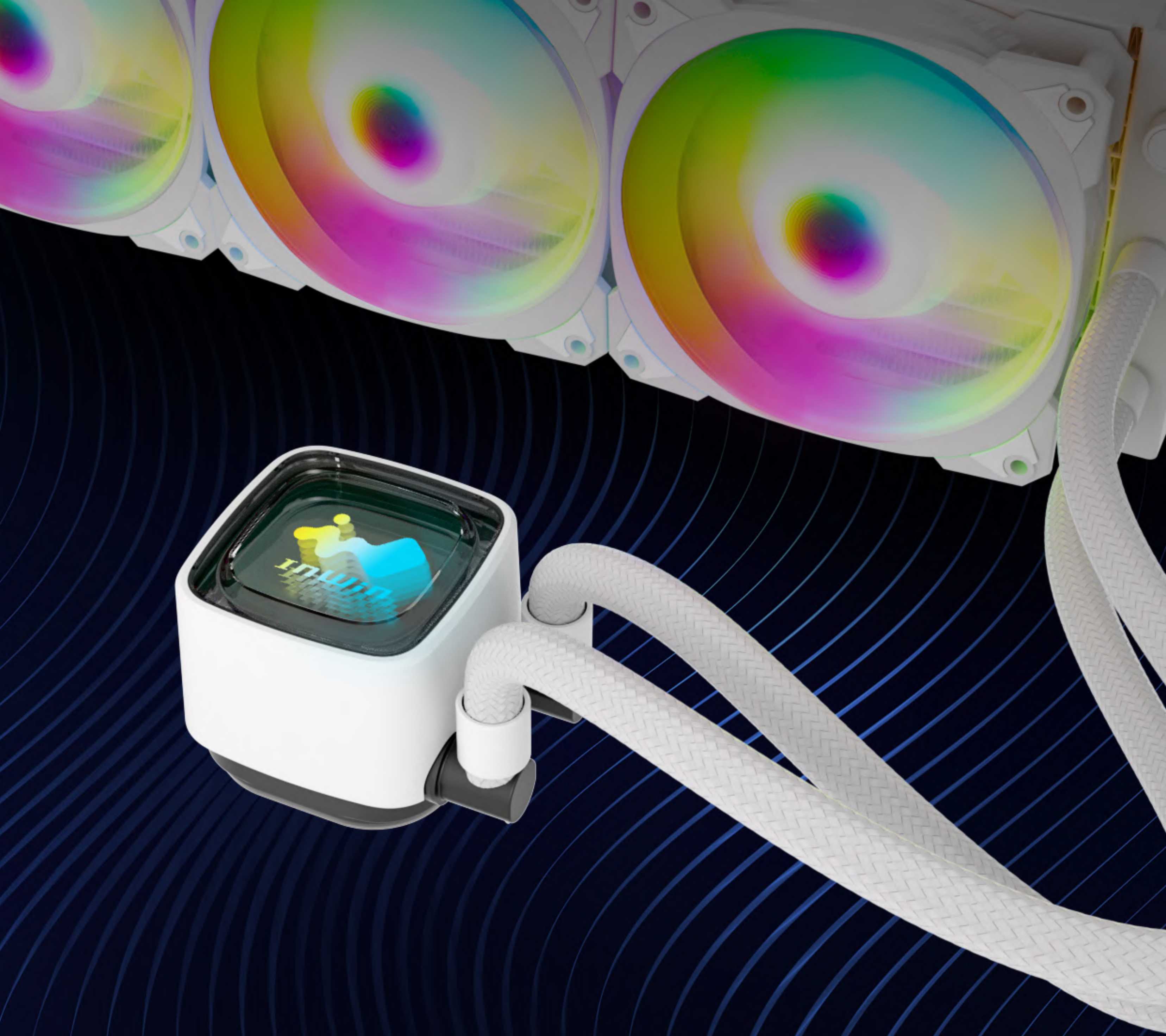

## Product Story

Bothered by a hot CPU and complex installations?

The AR All-in-One Liquid CPU Cooler offers high-performance cooling and effortless setup.

Equipped with three high-static-pressure Neptune AN120/AN120P fans and a striking ARGB infinity water block, delivering excellent thermal performance in style!



# Specifications



## AR36

Model		AR36	
Model Number		IW-LC-AR36BLK	IW-LC-AR36WHI
Colors		Black	White
CPU Socket Support		Intel® LGA 1851/ 1700/ 15xx/ 1200/ 115x AMD AM5/ AM4/ AMx/ FMx	
Radiator	Dimensions (L x W x H)	397 x 120 x 27 mm 15.6 x 4.7 x 1.06"	
	Materials	Aluminium	
	Tube Length	450 mm	
	Tube Material	Rubber with Nylon Braided Sleeve	
Water Block	Dimensions (L x W x H)	65 x 65 x 56 mm 2.5 x 2.5 x 2.2"	
	Materials	Plastic	
Pump	Pump Speed	3100 +/- 10% RPM	
	Power	DC 12V, 0.28A (0.3A MAX)	
Fans	Model	Neptune AN120	Neptune AN120P
	Quantity Included	3 PCS	
	Dimensions (L x W x H)	120 x 120 x 25 mm 4.7 x 4.7 x 1.0"	
	Speed Mode	PWM 900 - 2200 +/- 10% RPM	
	Noise Level	20.5 dB(A) (Normal)	
	Airflow	23.87 - 60.1 CFM	
	Static Pressure	0.36 - 2.27 mm / H2O	
	Connectors	4-Pin (12V, PWM), 3-Pin (5V, ARGB)	
	Bearing Type	Long Lifespan Sleeve Bearing	
Package Contents		1 x InWin AR36 Liquid CPU Cooler	
		3 x InWin Neptune AN120 Fans	3 x InWin Neptune AN120P Fans
		Accessories Bag	
Package Dimensions (L x W x H)		448 x 137 x 205 mm 17.6 x 5.3 x 8"	
Net Weight		1.8 Kg / 2.2 lbs	
Gross Weight		2.4 Kg / 5.2 lbs	
Warranty		3 Years	

\* InWin's products comply with RoHS regulation.

\* Specifications may vary based on different regions.



# AR36 Package Contents

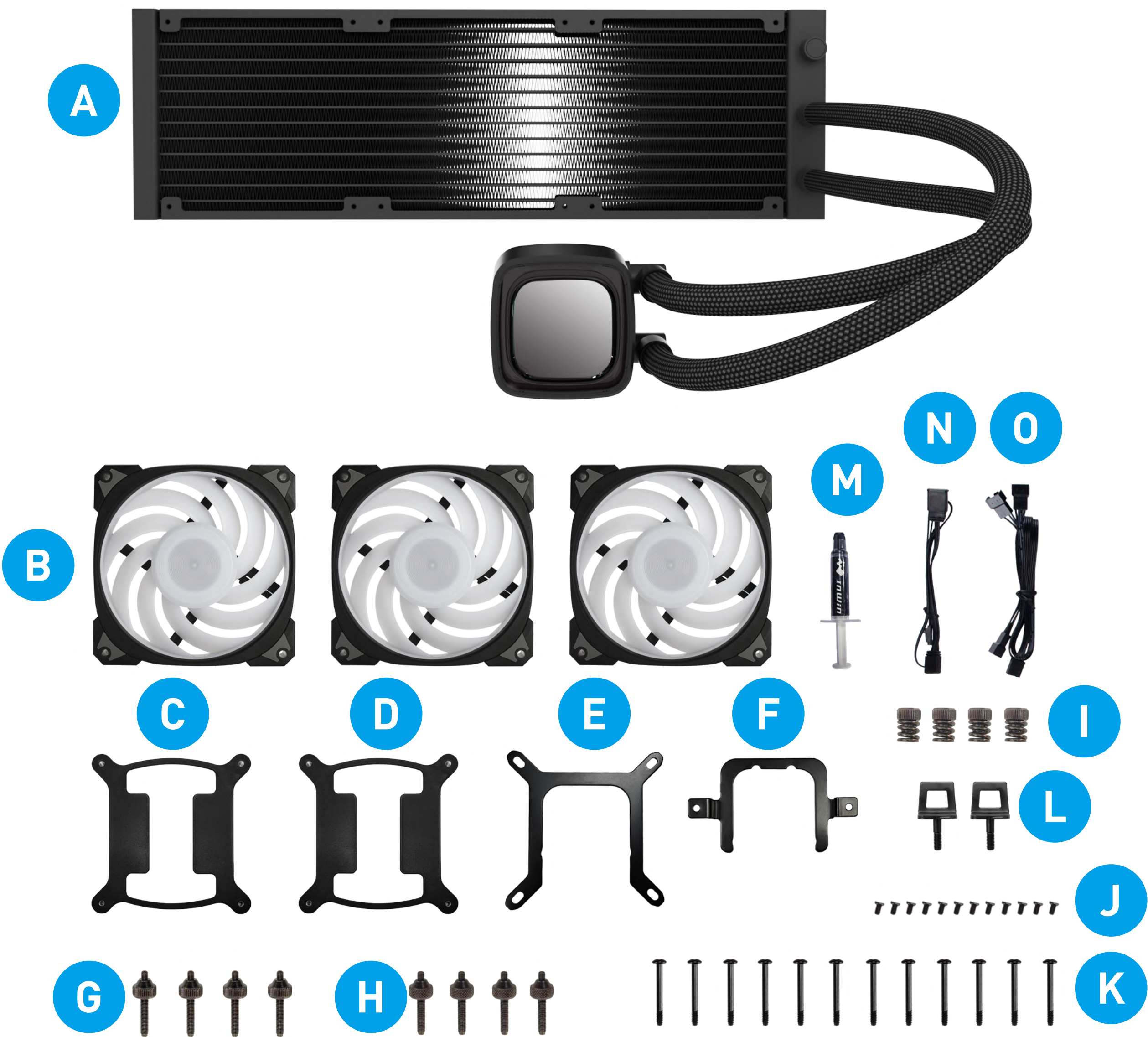

Contents			AR36
Radiator	A	360 mm Radiator	1
Fan	B	Neptune AN120 Fan	3
Accessories Bag	C	Intel LGA 1851 / 1700 CPU Backplate	1
	D	Intel 115x / 1200 CPU Backplate	1
	E	Intel Mounting Bracket	1
	F	AMD Mounting Bracket	1
	G	Standoff Screws (LGA 115X/1200)	4
	H	Standoff Screws (LGA 1851/1700)	4
	I	Thumbscrew Caps	4
	J	Radiator Screws	12
	K	Fan Screws	12
	L	AMD Mounting Bolt	2
	M	Thermal Compound	1
	N	ARGB Extension Cable 500 mm	1
	O	PWM Extension Cable 500 mm	1



# Installation

Intel LGA 1851/ 1700/ 1200/ 1151/ 115x CPU

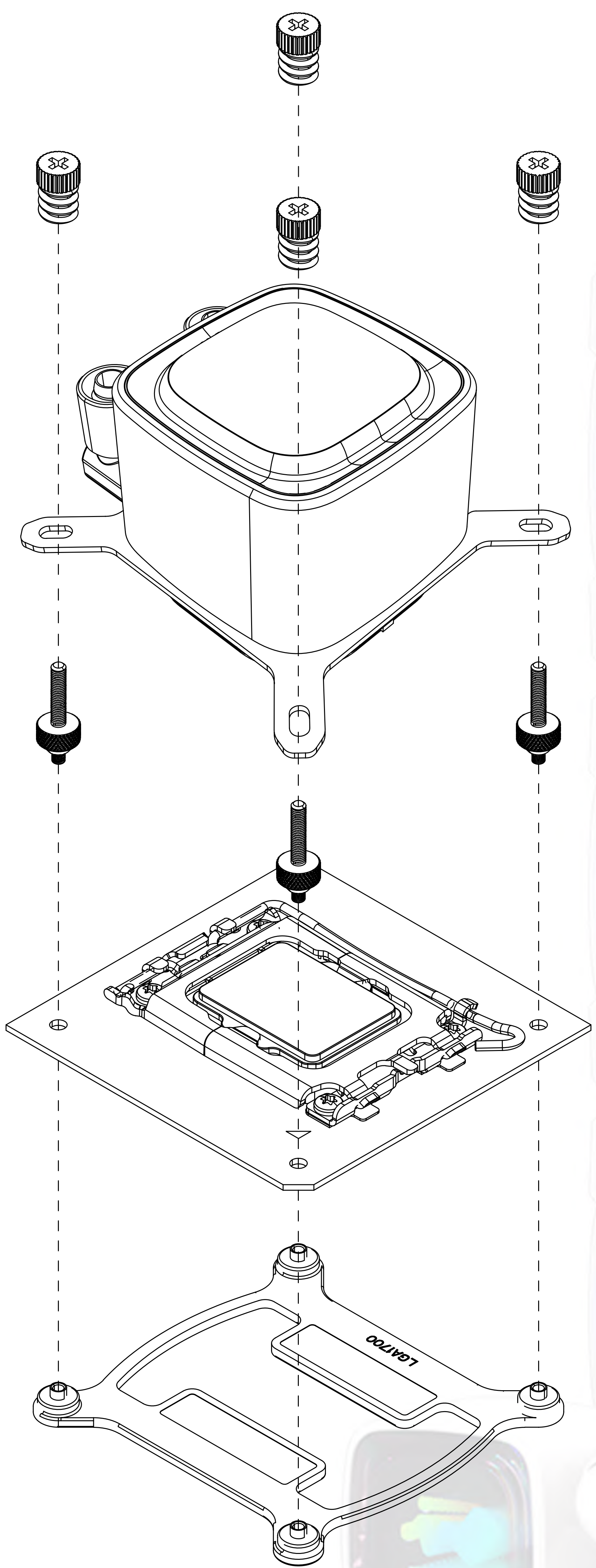

# Installation

## AMD AM5/ AM4/ AMx/ FMx CPU

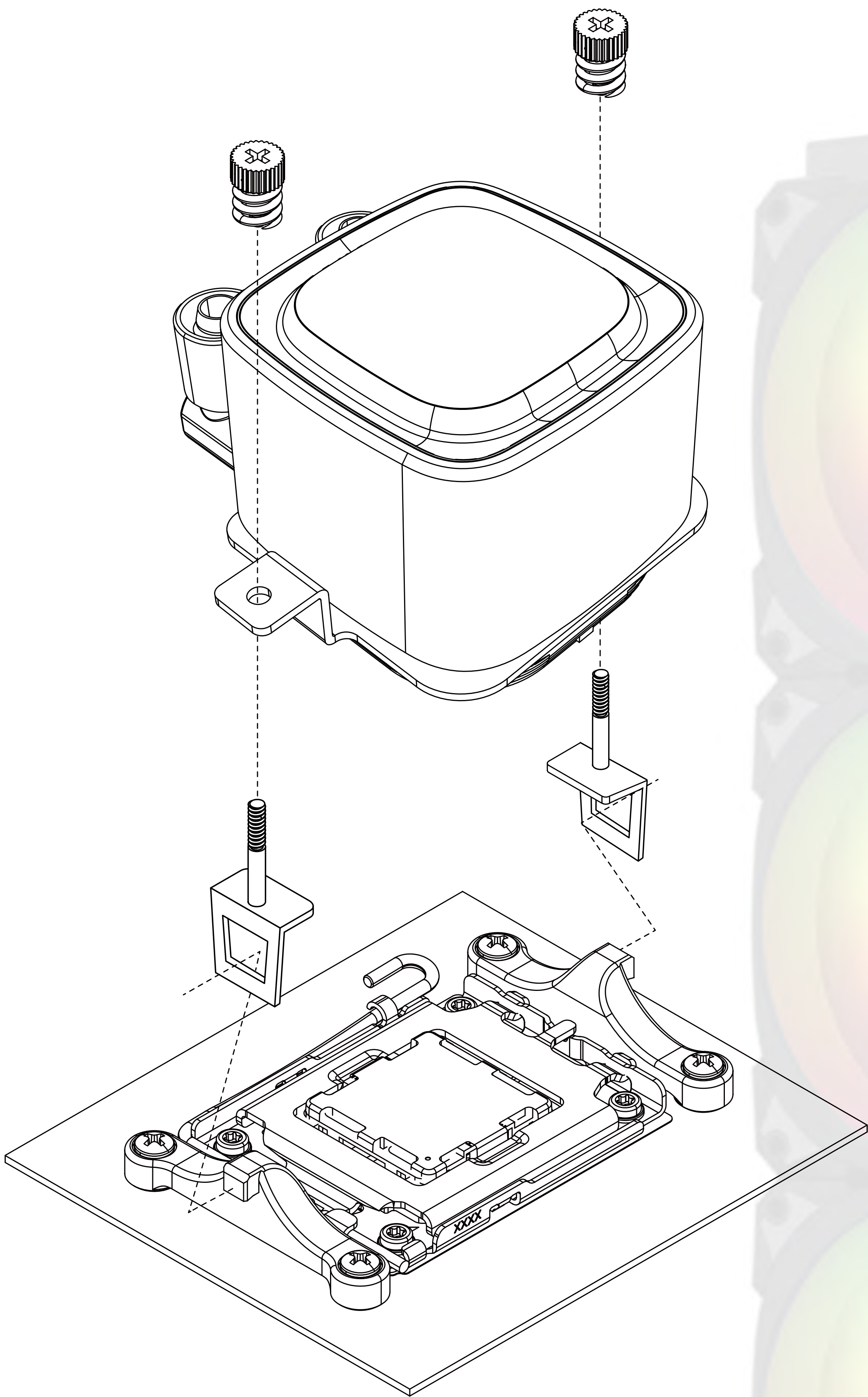



# Connection Cables

## ARGB Water Block Cable / Pump Cable

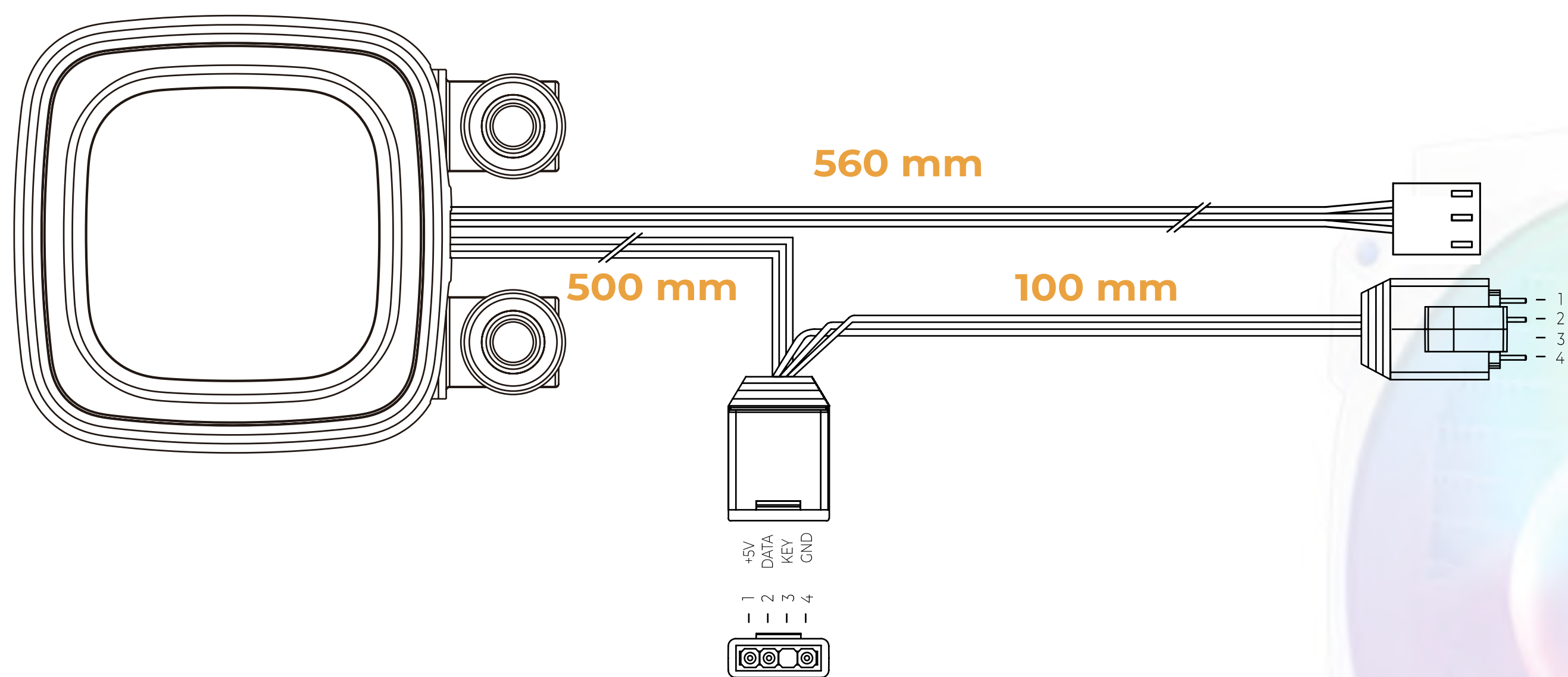

## PWM Fan Extension Cable

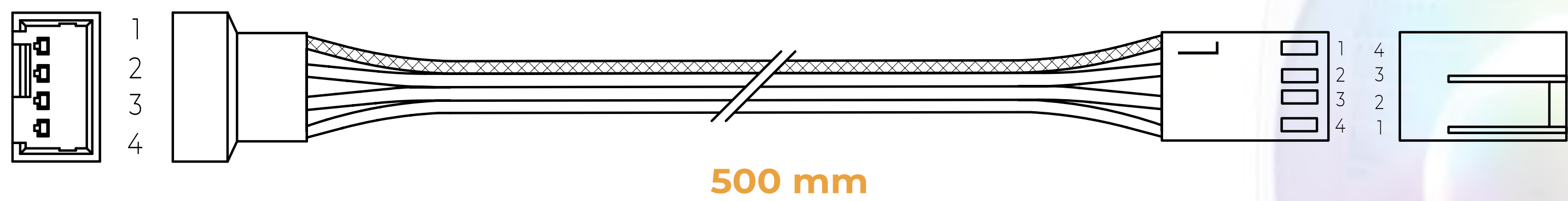

## ARGB Extension Cable

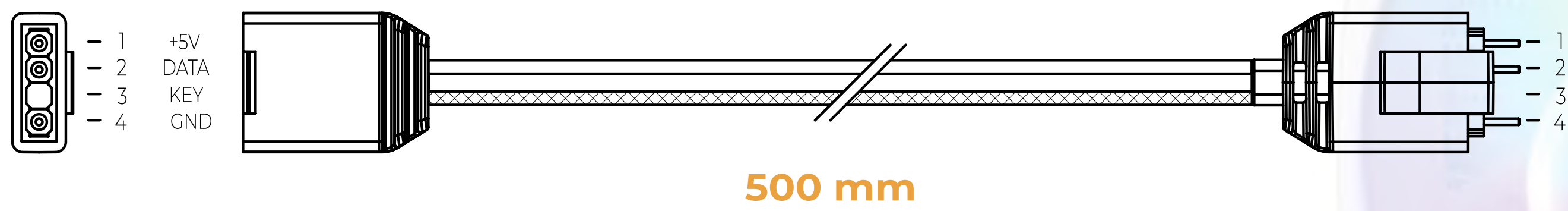



# Connection Cables

Please connect the cable according to the instruction below.

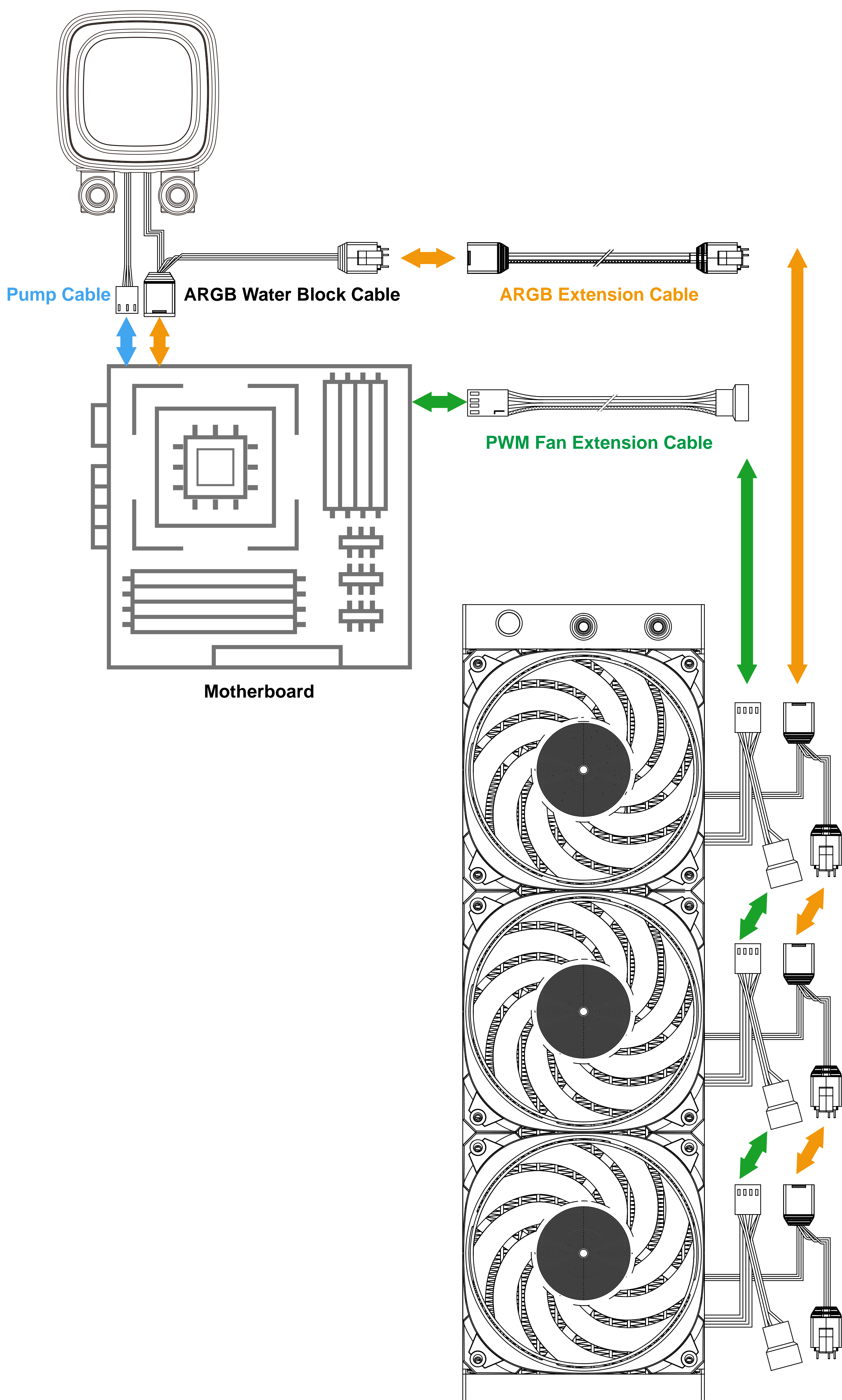



# Troubleshooting

**If your AIO pump or fan does not operate properly, please follow the instructions below:**

1. Please check your system's power.
2. Please make sure all the connectors are connected properly.
3. For more technical support, please visit the InWin Forum at <https://forum.in-win.com/>

## Notices & Warranty

### ■ Notices

1. Install in accordance with the user manual's instructions and safety warnings. Incorrect installation may burnout the motherboard and other system components.
2. Keep this product away from areas with high temperatures such as: heat dissipation machines, air conditioners or other machines which may generate high temperatures.
3. Please do not put anything in the impeller.
4. Do not modify the cables and/or connectors included with this product.
5. Please do not put your hands or other objects into the fan blades when the fan is in operation. And please make sure to keep away from children and pets.
6. Please only use this product in a computer case.
7. Please keep this product away from any liquids.
8. Please use only this product's exclusively supplied cables. Other cables may not be compatible and could cause serious damage to your system and power supply.

### ■ Warranty

1. For more detailed warranty information, please visit the InWin retail website at [www.in-win.com](http://www.in-win.com).
2. The actual product is subject to change without prior notice.  
IN WIN DEVELOPMENT INC. reserves the right to make any final modifications.





***inWin***

CONTEMPORARY & INNOVATIVE  
w w w . i n - w i n . c o m

**Copyright © 2024 In Win Development Inc.  
All Rights Reserved.**